

# WALL MOUNTED CYLINDER

Selectable Direction (Up / Down / Both)  
Selectable CCT (3000K / 4000K / 5000K)

Architectural grade ADA compliant up-and-down wall mount cylinder with two dedicated COB LEDs mounted in the up and down position. Each cylinder includes two integral switches to change the direction of light and color temperature after installation. IP65 and wet location rated for most indoor and outdoor applications.



## FEATURES

- Delivering 3000 lumens (1500lm per direction)
- ADA compliant, no mounting height requirement
- Easily installs over junction box
- Two built-in switches to control direction of light and CCT
- 120-277V input; 0-10V dimming
- Selectable CCT (3000K / 4000K / 5000K)
- 90+ CRI for superior color rendition without sacrificing output
- Three powder coat finishes (black, bronze or matte powder white)
- Versatile up-and-down lighting design (up, down, or both)
- cETLus Listed for Wet Locations
- IP65 rated
- 5-Year Limited Warranty
- Certified to the high efficacy requirements of California Title 24 JA8-2022

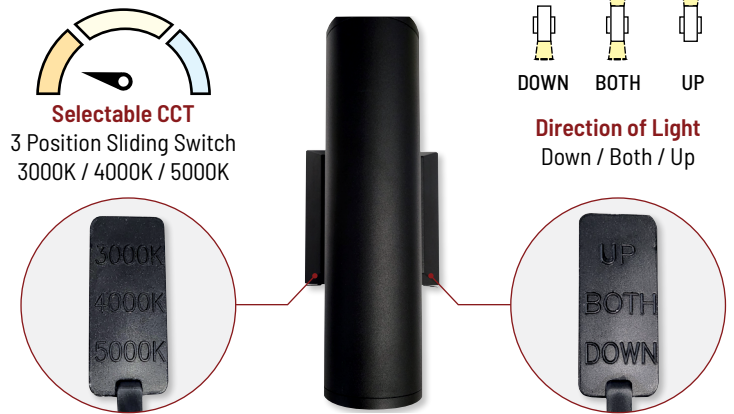

### 3" UP & DOWN WALL MOUNTED CYLINDER

FINISH

<a href="#">NYUD-3L1345B</a>	Black
<a href="#">NYUD-3L1345BZ</a>	Bronze
<a href="#">NYUD-3L1345MPW</a>	Matte Powder White

