

# Installation Instructions

## NSLIM-4REGL1TWPW

### 4" Slim Regressed LED Surface Mount

**READ PRIOR TO ATTEMPTING INSTALLATION**  
**ALWAYS TURN OFF MAIN POWER BEFORE INSTALLATION**  
**INSTALLATION SHOULD BE CARRIED OUT BY YOUR LOCAL ELECTRICIAN**

**⚠ WARNING:** Risk of fire or electric shock. Installation of this retrofit assembly requires a person familiar with the construction and operation of the luminaire's electrical system and the hazard involved. If not qualified, do not attempt installation. Contact a qualified electrician.

**⚠ WARNING:** Risk of fire or electric shock. Install this kit only in the luminaires that has the construction features and dimensions shown in the photographs and/or drawings.

**⚠ WARNING:** To prevent wiring damage or abrasion, do not pinch or damage exposed wiring during installation. Keep away from edges of sheet metal or other sharp objects.

**⚠ WARNING:** Risk of fire or electric shock. Do not alter, relocate, or remove wiring, lampholders, power supply, or any other electrical component.

**DO NOT MAKE OR ALTER ANY OPEN HOLES IN AN ENCLOSURE OF WIRING OR ELECTRICAL COMPONENTS DURING KIT INSTALLATION.**

**THIS RETROFIT KIT IS ACCEPTED AS A COMPONENT OF A LUMINAIRE WHERE THE SUITABILITY OF THE COMBINATION SHALL BE DETERMINED BY AUTHORITIES HAVING JURISDICTION.**

**EXAMINE ALL PARTS THAT ARE NOT INTENDED TO BE REPLACED BY THE RETROFIT KIT FOR DAMAGE AND REPLACE ANY DAMAGED PARTS PRIOR TO INSTALLATION OF THE RETROFIT KIT.**

**MIN. 90°C SUPPLY CONDUCTORS / LES FILS D'ALIMENTATION 90°C MIN.**

**⚠ AVERTISSEMENT:** Risque d'incendie ou de choc électrique. L'installation de cet ensemble de rénovation nécessite une personne familiarisée avec la construction et le fonctionnement du système électrique du luminaire et les risques encourus. S'il n'est pas qualifié, n'essayez pas d'installer. Contacter un électricien qualifié.

**⚠ AVERTISSEMENT:** Risque d'incendie ou de choc électrique. Installez ce kit uniquement dans les luminaires qui ont les caractéristiques de construction et les dimensions indiquées sur les photographies et / ou les dessins.

**⚠ AVERTISSEMENT:** Pour éviter d'endommager ou d'abrasion le câblage, ne pas pincer ou endommager le câblage pendant l'installation. Tenir à l'écart des bords de la tôle ou d'autres objets tranchants.

**⚠ AVERTISSEMENT:** Risque d'incendie ou de choc électrique. Ne modifiez pas, ne déplacez pas ou n'enlevez pas le câblage, les douilles de lampe, l'alimentation électrique ou tout autre composant électrique.



#### PACKAGING CONTENTS

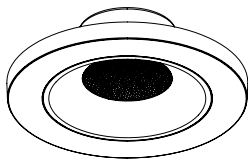

LED Luminaire

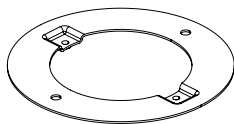

Surface Mount Bracket

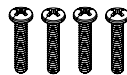

(4) 8-32 Mounting Screws



(3) Wire Nuts, Twist-Lock

#### COMPATIBLE JUNCTION BOXES

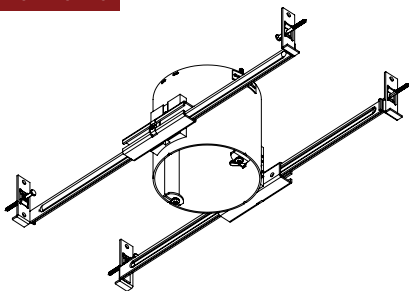

NFJB-R4S  
4" Fire Rated IC Air-Tight Junction Box Housing

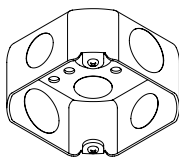

4" Octagonal Junction Box

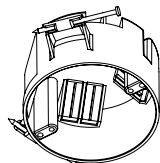

4" Plastic Round Junction Box

#### SELECTING COLOR TEMPERATURE

**NOTE:** Luminaire is preset to 3000K and may have been changed in shipping / handling.

Select desired color temperature prior to installation.

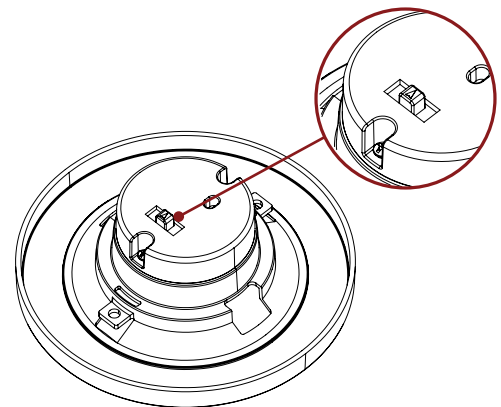

# Installation Instructions

## NSLIM-4REGL1TWMPW

### 4" Slim Regressed LED Surface Mount

READ PRIOR TO ATTEMPTING INSTALLATION  
ALWAYS TURN OFF MAIN POWER BEFORE INSTALLATION  
INSTALLATION SHOULD BE CARRIED OUT BY YOUR LOCAL ELECTRICIAN

#### SURFACE MOUNT INSTALLATION

- 1** Install the mounting bracket to the junction box with 2 screws through the keyholes.

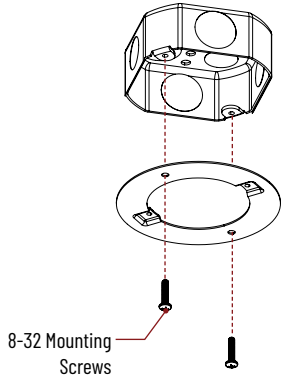

- 2** Twist the reflector counterclockwise to detach from luminaire.

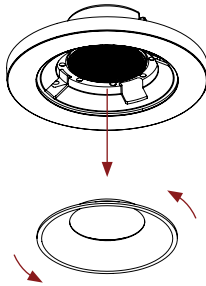

- 3** Connect luminaire to supply wires. Align via grooves and fasten the luminaire to the junction box by two screws through the keyhole.

Neutral	White
Ground	Green
Line	Black

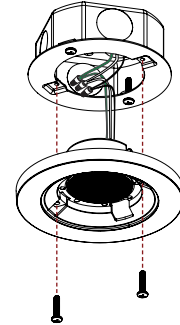

- 4** Twist the reflector clockwise onto the luminaire.

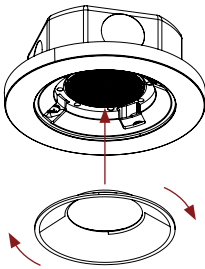

- 5** Installation complete.

