

NTL-264

MR16 V-Tec Gimbal Style Low Voltage Track

Lamp: 20W - 50W Halogen MR16

Type _____

Project _____

Catalog No. _____

Notes _____

PRODUCT DESCRIPTION

Universal open back gimbal ring for cool operation. Vertical design extends life of the transformer. Low profile, simple and clean gimbal appearance.

FEATURES

- Clear shield included with fixture
- High strength stainless steel electrical contacts
- One or two circuit track capable

CONSTRUCTION

Contact Head Assembly: Three .030 stainless steel contacts mounted in high heat rated plastic housing.

Housing: .030 die-cast aluminum construction. All edges are softened for aesthetic appearance.

ELECTRICAL

Voltage: 120V input

Socket: Porcelain socket for GU5.3 12V MR16 lamp

Lamp: 20W - 50W Halogen MR16 (not included)

ONE/TWO CIRCUIT CONVERSION

Positive contact (opposite neutral and ground contacts) is preset to "down" position at factory but may be raised to the higher position to install onto the second circuit of Nora Lighting NT- 2300 series two-circuit track.

OPTIONAL ACCESSORIES

NM-100/MR16: MR16 Filter (Blue, Clear, Frosted, Green, Linear, Pink, Red, Spread, Yellow)

LABELS AND LISTINGS

UL Listed



PRODUCT IMAGES AND DIMENSIONS



B
Black



S
Silver

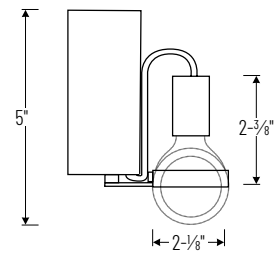

MR16 V-Tec Gimbal Style Low Voltage Track

Catalog No.	Finish
NTL-264	B = Black S = Silver

Optional Accessories

Description
NM-100/MR16 = MR16 Filter

Example: **NTL-264B** = MR16 V-Tec Gimbal Style Low Voltage Track, Black Finish