

Installation Instructions

URGENT: READ PRIOR TO ATTEMPTING INSTALLATION

NORA RAIL LINE VOLTAGE CORD PENDANT FIXTURES



ALWAYS TURN OFF MAIN POWER BEFORE INSTALLATION

Details on how to adjust the cord length via the strain relief at the top of the cord on Rail and Yoyo fixtures

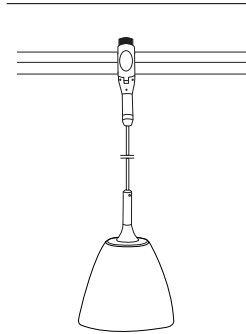

NRS19-456
NRS19-450
NRS19-462
NRS19-463
 With your particular glass

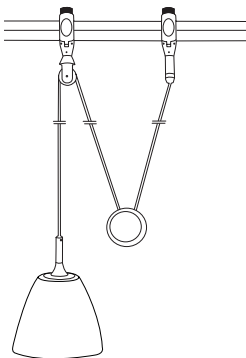

NRS19-551
NRS19-562
NRS19-563
 With your particular glass

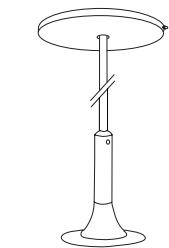

NRS99-P45
NRS99-P46
 With your particular glass

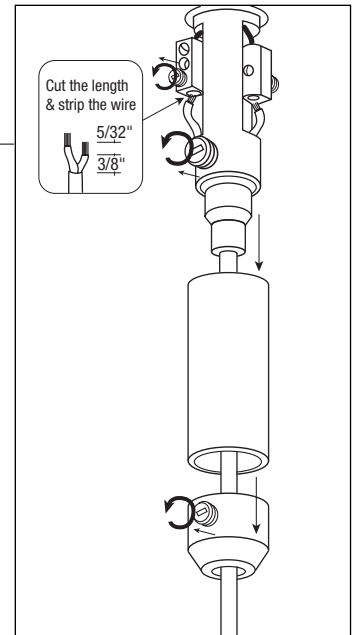
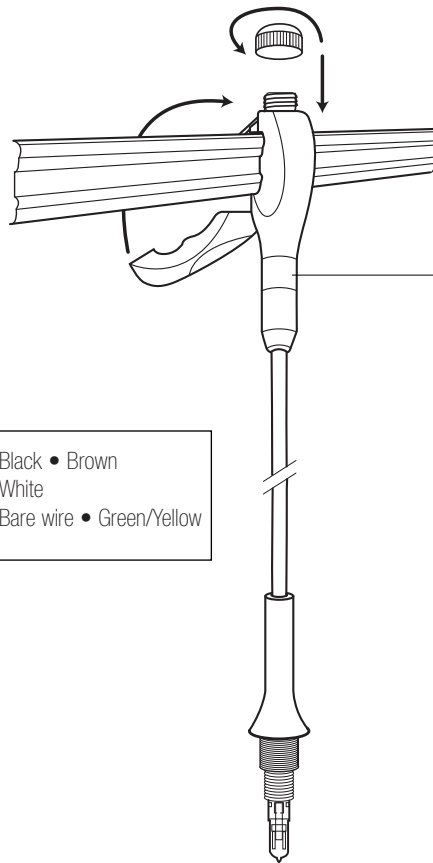
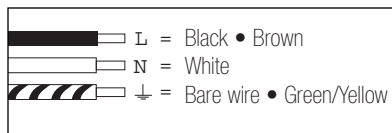

Each glass has its own unique characteristics. Because the glass can have different thickness we have provided numerous fittings to ensure the glass is properly secured.

Please utilize the washer that best fits your glass. (2 provided)

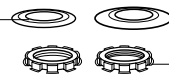
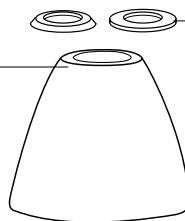

Two different fittings are provided Please utilize the one that best fits your glass.

Two nuts are provided that can fit different sections of the socket as needed. They can be utilized in conjunction with the spacer if needed.

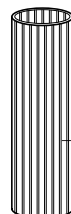

Please ensure the glass is level before locking the nut(s) down with the plastic tube wrench.

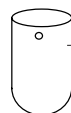

Screw-on glass shield over bulb.

INSTALLATION SHOULD BE CARRIED OUT BY YOUR LOCAL ELECTRICIAN.