

# NQZ-4R-F

New Construction Frame-In with Collar for 4" Can-less Downlights

Type

Project

Catalog No.

Notes

## PRODUCT DESCRIPTION

New construction frame-in with collar can be used to assist installing can-less downlights.

**Mounting:** Bar hangers are adjustable from 13-3/4" to 26" with integral nails. Bar hangers are slotted for T-bar ceiling grids.

## COMPATIBLE LUMINAIRE

[NQZ2-4ITWTW-MPW](#): 4" Quartz LED Downlight

## PRODUCT IMAGES AND DIMENSIONS

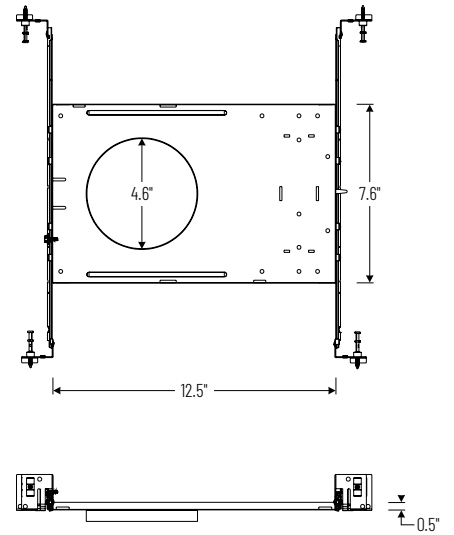

## New Construction Frame-In

Description

**NQZ-4R-F** = New Construction Frame-In with Collar

## Compatible Luminaire

Description

**NQZ2-4ITWTW-MPW** = 4" Quartz LED Downlight

Example: **NQZ-4R-F** = New Construction Frame-In with Collar