

Installation Instructions

NYLM-ST

iLENE LED Mini Cylinders - Stem Mount

READ PRIOR TO ATTEMPTING INSTALLATION
ALWAYS TURN OFF MAIN POWER BEFORE INSTALLATION
INSTALLATION SHOULD BE CARRIED OUT BY YOUR LOCAL ELECTRICIAN

⚠ IMPORTANT - This equipment is intended to be installed only by qualified personnel. The installation must be made in accordance with the current edition of the National Electrical Code and all applicable state and local building codes. The final installation must be approved by the appropriate, qualified electrical/building inspector(s). Improper installation may result in a fire or electrical hazard. Be sure the electrical power to the circuit has been disconnected before installing this electrical system.

⚠ IMPORTANT - Cet équipement est destiné à être installé uniquement par du personnel qualifié. L'installation doit être faite conformément à l'édition actuelle du Code national de l'électricité et à tous les codes de construction locaux et nationaux applicables. L'installation finale doit être approuvée par un ou plusieurs inspecteurs qualifiés en électricité / bâtiment. Une installation incorrecte peut entraîner un incendie ou un risque électrique. Assurez-vous que l'alimentation électrique du circuit a été déconnectée avant d'installer ce système électrique.



PACKAGING CONTENTS

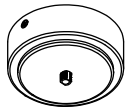

Canopy

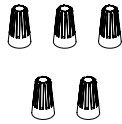

(5) Wire Nuts, Twist-Lock

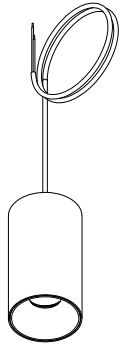

iLENE Assembly



Stems

COMPATIBLE JUNCTION BOXES

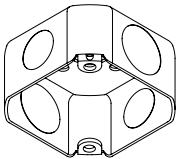

3" Octagonal Junction Box

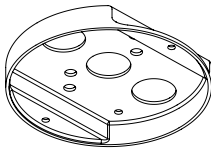

3" Pancake Junction Box

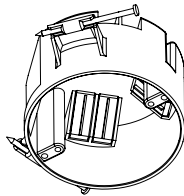

4" Round Non-Metallic
(Carlton B618R)

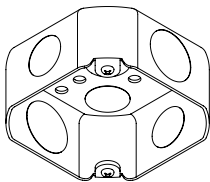

4" Octagonal Junction Box
Metallic or Non-Metallic
(Carlton A615)

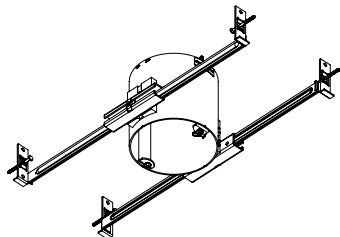

NFJB-R4S
4" Fire Rated IC Air-Tight Junction Box Housing

EXPLODED VIEW

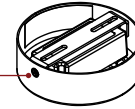

Canopy



Threaded Coupler



12" Stem

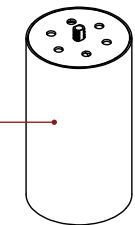

Cylinder

Installation Instructions

NYLM-ST

iLENE LED Mini Cylinders - Stem Mount

READ PRIOR TO ATTEMPTING INSTALLATION
ALWAYS TURN OFF MAIN POWER BEFORE INSTALLATION
INSTALLATION SHOULD BE CARRIED OUT BY YOUR LOCAL ELECTRICIAN

INSTALLATION INSTRUCTIONS

1. Make sure electrical power is off.
2. Remove junction box bracket from canopy to access driver then detach driver from driver bracket to access canopy opening. (Figure 1)
3. Insert wire from cylinder body through all stem(s), threaded coupler(s) and canopy. (Figure 2)
4. Thread stems together with threaded coupler. Thread assembled stems to canopy and cylinder. (Figure 3)
5. Connect the driver's output wires to the LED wire from stem(s). (Figure 4)
6. Connect the driver's input wires to the junction box wires. (Figure 5)
Black to black, white to white. For 0-10V dimming: purple to purple, pink to pink. (LE4 option)
7. Reattach driver to driver bracket once output wires are connected.
8. Secure bracket on the junction box and mount the canopy with the LED driver to the bracket. (Figure 6)
9. Check the connections and turn the power on.

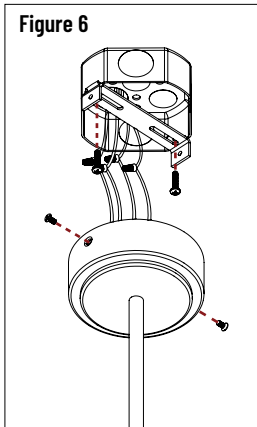
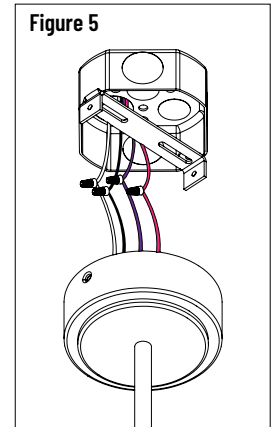
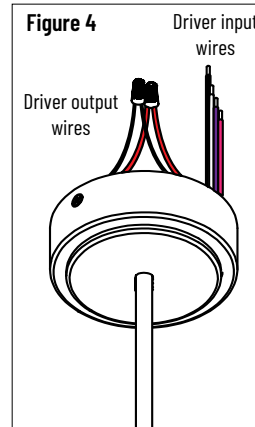
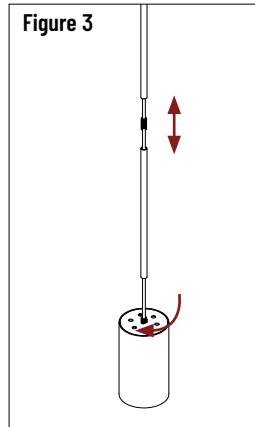
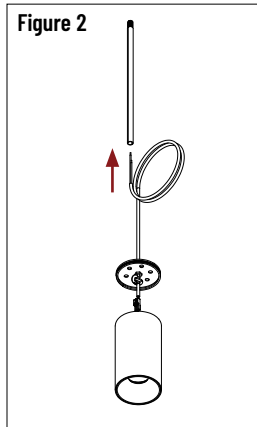
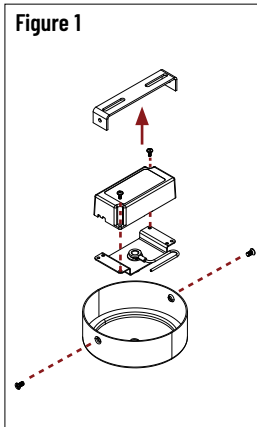

Installation Instructions

NYLM-ST

iLENE LED Mini Cylinders - Stem Mount

READ PRIOR TO ATTEMPTING INSTALLATION
ALWAYS TURN OFF MAIN POWER BEFORE INSTALLATION
INSTALLATION SHOULD BE CARRIED OUT BY YOUR LOCAL ELECTRICIAN

CHANGING OPTIC

1. Make sure electrical power is off.
2. Twist open top cover.
3. a.) Remove the module by using a flat screwdriver to turn the heat sink counter clockwise between the heat sink fins. (Figure 1)
b.) unscrew cap from module
4. Remove optic from module and replace with desired optic.
5. Replace the module and lock the top cover.

