

NIOP-1RTC  
1" iPOINT Cone Monopoint  
Source: 9W or 10W LED  
900lm

Type
Project
Catalog No.
Notes

PRODUCT DESCRIPTION

The iPOINT LED monopoint is the newest addition to the Iolite family. iPOINT luminaires require an Iolite housing, allowing the fixture to maintain a minimal canopy and sleek appearance. iPOINT fixtures produce from 750 to 1200 lumens at 90+ CRI with a choice of three kelvin temperatures from 2700K, 3000K or 4000K. Similar to Iolite reflectors, each iPOINT includes spot, narrow flood and flood optics which can be easily changed in the field. iPOINT is available in Cylinder or Cone styles in black or matte powder white. iPOINT luminaires can be dimmed with Triac, ELV, 0-10V or Lutron Hi-lume EcoSystem.

FEATURES

- Small appearance resembles a monopoint fixture
- LED COB technology
- Field changeable optics (three included)
- 5-Year limited warranty

SPECIFICATION

**Construction:** Low voltage luminaires are constructed of die-cast aluminum to dissipate heat. Fixtures' stem allows for vertical adjustment up to 70° and 359° rotation.

**Mounting:** Luminaires includes friction blades to mount securely to housing.

**Field Changeable Optics:** Each luminaire includes a spot, narrow flood and flood (pre-installed) optics. Fixture includes suction cup to assist in optic replacement.

**Finishes:** iPOINT is available in matte powder white or black. Matte powder white luminaire includes black insert for an alternative appearance.

ELECTRICAL

**Lumens:** 900lm (varies by finish, CCT and optic)

**Color Temperature:** 2700K, 3000K, 4000K

**Color Rendering Index:** 90+CRI

**Beam Spread:** 28° Spot, 39° Narrow Flood, 59° Flood

**Operating Temperature:** 0°C to 40°C ambient temperature

**Lifetime:** 50,000 hours @ L70

**Dimming:** Specified by housing

COMPATIBLE HOUSINGS

Reflectors **require** an Iolite housing manufactured by Nora Lighting.

CATALOG NO.	DESCRIPTION
NHIOICD-16	1" IC Air-Tight New Construction
NHIOICDCP-16	1" Chicago Plenum New Construction
NHRIIC-16	1" IC Air-Tight Remodel

LABELS AND LISTINGS

- cULus Listed for Damp Location
- [5-Year Limited Warranty](#)
- Certified to the high efficacy requirements of California Title 24 JA8-2022



PRODUCT IMAGES & DIMENSIONS



**BB**  
Black Interior  
Black Exterior



shown with  
black insert  
  
**MPW**  
Matte Powder White Interior  
Matte Powder White Exterior

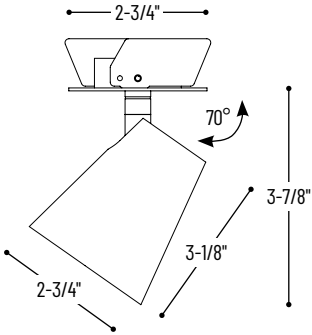

1" iPOINT Cone Monopoint - Dedicated Housing Required

Fixture Type	Color Temp. / CRI	Finish
NIOP-1RTC = Cone	<b>27X</b> = 2700K / 90 CRI	<b>BB</b> = Black Interior / Black Exterior
	<b>30X</b> = 3000K / 90 CRI	<b>MPW</b> = Matte Powder White Interior / Matte Powder White Exterior
	<b>40X</b> = 4000K / 90 CRI	

Example: **NIOP-1RTC27XMPW** = 1" iPOINT Cone, 2700K / 90 CRI, Matte Powder White finish

# NHIOICD-16 / NHIOICDCP-16

1" Iolite IC Air-Tight New Construction Housing  
Source: 9W or 10W LED

Type

Project

Catalog No.

Notes

## PRODUCT DESCRIPTION

New construction housing for use in insulated ceilings can be in direct contact with insulation\*\*. Air-tight construction provides energy savings by reducing the flow of air through the ceiling. Patented design allows for easy, tool-less removal of the driver.

## FEATURES

- IC rated for direct contact with insulation\*\*
- Quick connect provided for electrical connection to the LED reflector
- ASTM E283 for Air-Tight
- Dimming down to 5%
- Patented driver assembly

## SPECIFICATION

**Housing:** 0.040" Aluminum shallow housing with patented driver assembly, allows for driver to slide out without tools. Housing can be installed in 1/2" ceiling thickness, an extension collar is available for ceiling thickness up to 2", must specify NIO-1EXTC2.

**Air Flow Restriction:** Meets requirements of Air-Tight (AT) <2CFM (cubic feet per minute) in accordance with ASTM-283 Air-Tight requirements.

**Clearance\*\*:** "IC" Insulated ceiling housings are direct contact rated. Not to be used in direct contact with spray foam insulation.

**Bar Hangers:** Two 13-3/4" to 24-1/2" adjustable bar hangers with captive nails are included on housing. Bar hangers are parallel to junction box, but can be repositioned 90° perpendicular to junction box if desired. "L"-shaped bar hanger foot to align to bottom of construction joist. A T-bar notch allows for easy installation in a suspended ceiling.

**Junction Box:** Pre-wired 25 cubic inch 0.064" thick galvanized steel, with seven 1/2" knockouts, four Romex® pryouts, and snap on covers. All leads are #18AWG wire, the ground wire is connected to the bottom, and quick connectors are supplied on all leads. Through branch circuit wiring, (4-in, 4-out). Access above ceiling required.  
**ACCESS ABOVE CEILING REQUIRED.**

## ELECTRICAL

**Voltage:** 120V or 120/277V (must specify)

**Power Factor:** >0.90

**Operatin Temp.:** 104°F (40°C) max. ambient temperature

**Wattage:** 9W (LE3) or 10W (LE4)

**Dimming:** Triac / ELV or 0-10V (must specify)

[Click Here](#) or check complete dimmer list at [www.NoraLighting.com](http://www.NoraLighting.com) in the "Compatibility" page under "Resources" tab

## COMPATIBLE REFLECTORS

CATALOG NO.	DESCRIPTION
NIOB-1RNB	1" Round Bullnose (BWF)
NIOB-1SNB	1" Square Bullnose (BWF)
NIOB-1RNG	1" Round Straight Regress (BWF)
NIOB-1SNG	1" Square Straight Regress (BWF)
NIOB-1RPH	1" Round Pinhole (BWF)
NIOB-1RSL	1" Round Adj. Slot Aperture (BWF)
NIO-1RNB	1" Round Bullnose (NTF)
NIO-1SNB	1" Square Bullnose (NTF)
NIO-1RNG	1" Round Straight Regress (NTF)
NIO-1SNG	1" Square Straight Regress (NTF)
NIOP-1RCY	1" iPOINT Cylinder
NIOP-1RTC	1" iPOINT Cone

**Emergency:** Housing can be specified with connections for emergency battery installation. Requires top access. Must specify battery with remote test switch separately, NEPK-07LEDUNV.

## LABELS AND LISTINGS

- cULus Listed for Damp Location (Wet Location when used with compatible reflector)
- [5-Year Limited Warranty](#)
- RoHS Compliant
- Patent #D824567S
- Meets or exceeds ASTM-283 Air-Tight requirements



## PRODUCT IMAGES AND DIMENSIONS

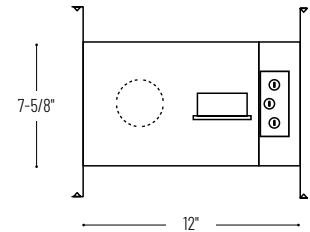
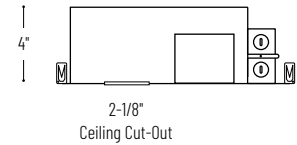

## 1" Iolite IC Air-Tight New Construction Housing

Housing Type	Driver / Dimming	Optional Emergency Wiring
NHIOICD-16 = IC Air-Tight	LE3 = 120V input; Triac / ELV dimming	/PEM = Remote Emergency
NHIOICDCP-16 = Chicago Plenum	LE4 = 120-277V input; Triac / ELV / 0-10V dimming	

## Optional Accessories

Description
NEPK-07LEDUNV = Remote Emergency Battery w/Test Switch
NIO-1EXTC2 = Ceiling Extension Collar up to 2"

Example: NHIOICD-16LE3 = 1" Iolite IC Air-Tight New Construction Housing, 120V input; Triac / ELV dimming

NHR10IC-16LE4

1" Iolite IC Air-Tight Remodel Housing  
Source: 10W LED

PRODUCT DESCRIPTION

Dedicated remodel housing for use in insulated ceilings can be in direct contact with insulation\*\*. Air-tight construction provides energy savings by reducing the flow of air through the ceiling.

FEATURES

- IC rated for direct contact with insulation\*\*
- Quick connect provided for electrical connection to the LED reflector
- ASTM E283 for Air-Tight
- Dimming down to 5%

SPECIFICATION

**Housing:** 0.030 steel can connects to integrated 0.040 steel structural arm with junction box and driver compartment. Integral spring brackets provided. Remodel housing swivels up to 35° depending on ceiling thickness. New construction flat frame available to convert remodel housing, must specify NH10FK-1.

**Air Flow Restriction:** Housing has factory installed gaskets to restrict airflow from room into ceiling plenum to <2CFM (cubic feet per minute) in accordance with ASTM-283 Air-Tight requirements.

**Clearance\*\*:** "IC" Insulated ceiling housings are direct contact rated. Not to be used in direct contact with spray foam insulation.

**Mounting:** Four high-tension tempered steel springs secure remodel housing from 1/4" (min) to 5/8" (max) thick ceiling. Hole cutout template provided for convenience.

**Junction Box:** Pre-wired 25 cubic inch 0.064" thick galvanized steel, with five 1/2", two 3/4" knockouts, four Romex® pryouts, and snap on covers. All leads are #18AWG wire, the ground wire is connected to the bottom, and quick connectors are supplied on all leads. Through branch circuit wiring, (4-in, 4-out).

ELECTRICAL

**Voltage:** 120/277V  
**Power Factor:** >0.90  
**Operatin Temp.:** 104°F (40°C) max. ambient temperature  
**Wattage:** 10W  
**Dimming:** Triac / ELV or 0-10V  
[Click Here](#) or check complete dimmer list at [www.NoraLighting.com](http://www.NoraLighting.com) in the "Compatibility" page under "Resources" tab

COMPATIBLE REFLECTORS

CATALOG NO.	DESCRIPTION
NIOB-1RNB	1" Round Bullnose (BWF)
NIOB-1SNB	1" Square Bullnose (BWF)
NIOB-1RNG	1" Round Straight Regress (BWF)
NIOB-1SNG	1" Square Straight Regress (BWF)
NIOB-1RPH	1" Round Pinhole (BWF)
NIOB-1RSL	1" Round Adj. Slot Aperture (BWF)
NIOP-1RCY	1" iPOINT Cylinder
NIOP-1RTC	1" iPOINT Cone

**Accessory:** New construction flat frame available to convert remodel housing, must specify NH10FK-1.

LABELS AND LISTINGS

- cULus Listed for Damp Location
- cULus Listed for Wet Location (w/designated reflectors)
- [5-Year Limited Warranty](#)
- RoHS Compliant
- Meets or exceeds ASTM-283 Air-Tight requirements



Type
Project
Catalog No.
Notes

PRODUCT IMAGES AND DIMENSIONS



NHR10IC-16LE4  
1" Iolite IC Air-Tight Remodel Housing

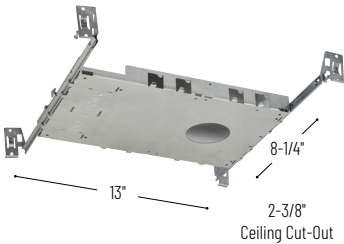
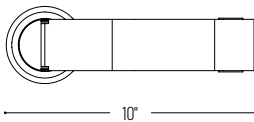
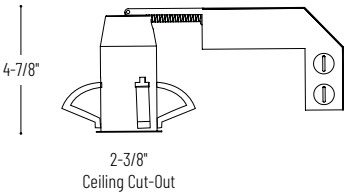

NH10FK-1  
New Construction Frame-In for 1" Remodel Housing

1" Iolite IC Air-Tight Remodel Housing

Driver / Dimming
NHR10IC-16LE4 = 120-277V input; 120V Triac / ELV / 0-10V or 277V 0-10V dimming

Optional Accessories

Description
NH10FK-1 = 1" New Construction flat frame with bar hangers

Example: NHR10IC-16LE4 = 1" Iolite IC Air-Tight Remodel Housing, 120-277V input; Triac / ELV / 0-10V dimming

PHOTOMETRICS

1" iPOINT Cone Monopoint

900 lumens

Type

Project

Catalog No.

Notes

Test Information

Test Number: NTR1494  
Part Number: NIOP-IRTC40XMPW  
Beam Spread: 28° Spot  
Lumens: 901lm  
Wattage: 8.77W  
Efficacy: 103lpw  
CCT / CRI: 4000K / 90 CRI  
Spacing Criteria (0°-180): 0.48  
Spacing Criteria (90°-270): 0.48

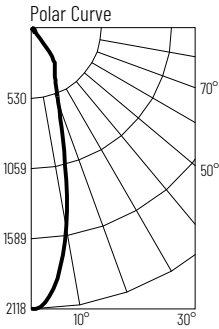

Illuminance at a Distance

Distance from Luminaire	FC at Nadir	Beam Diameter
4'	132fc	2'
6'	58.8fc	3'
8'	33.1fc	4'
10'	21.2fc	5'
12'	14.7fc	6'

Zonal Lumen Summary

Zone	Lumens	% Luminaire
0-30	643	71.4
0-40	809	89.8
0-60	871	96.7
0-90	899	99.8
90-180	2	0.2
0-180	901	100

Candela Table

Vertical Angles	Candela
0	2117
5	1958
15	956
25	434
35	305
45	43

Test Information

Test Number: NTR1495  
Part Number: NIOP-IRTC40XMPW  
Beam Spread: 39° Narrow Flood  
Lumens: 897lm  
Wattage: 8.77W  
Efficacy: 102lpw  
CCT / CRI: 4000K / 90 CRI  
Spacing Criteria (0°-180): 0.64  
Spacing Criteria (90°-270): 0.66

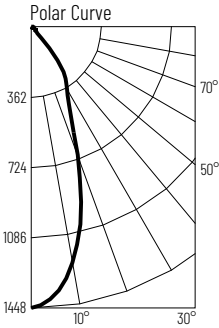

Illuminance at a Distance

Distance from Luminaire	FC at Nadir	Beam Diameter
4'	90.5fc	2'-10"
6'	40.2fc	4'-4"
8'	22.6fc	5'-8"
10'	14.5fc	7'-1"
12'	10.1fc	8'-6"

Zonal Lumen Summary

Zone	Lumens	% Luminaire
0-30	622	69.4
0-40	795	88.6
0-60	865	96.4
0-90	896	99.9
90-180	1	0.1
0-180	897	100

Candela Table

Vertical Angles	Candela
0	1448
5	1386
15	993
25	475
35	302
45	44

Test Information

Test Number: NTR1496  
Part Number: NIOP-IRTC40XMPW  
Beam Spread: 59° Flood  
Lumens: 898lm  
Wattage: 8.78W  
Efficacy: 102lpw  
CCT / CRI: 4000K / 90 CRI  
Spacing Criteria (0°-180): 0.86  
Spacing Criteria (90°-270): 0.88

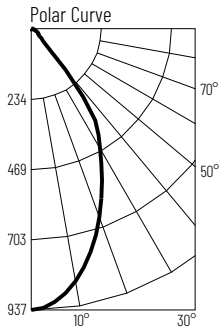

Illuminance at a Distance

Distance from Luminaire	FC at Nadir	Beam Diameter
4'	58.6fc	4'-6"
6'	26fc	6'-10"
8'	14.6fc	9'-1"
10'	9.4fc	11'-4"
12'	6.5fc	13'-7"

Zonal Lumen Summary

Zone	Lumens	% Luminaire
0-30	557	62
0-40	775	86.3
0-60	864	96.2
0-90	897	99.9
90-180	1	0.1
0-180	898	100

Candela Table

Vertical Angles	Candela
0	937
5	914
15	771
25	559
35	373
45	60

Lumen Output Multipliers

Color Temperature: 2700K (0.78), 3000K (0.91), 4000K (1.0)