

# Installation Instructions

## NELOCAC-16ST

### Stem Kit for 16" ELO

**READ PRIOR TO ATTEMPTING INSTALLATION**  
**ALWAYS TURN OFF MAIN POWER BEFORE INSTALLATION**  
**INSTALLATION SHOULD BE CARRIED OUT BY YOUR LOCAL ELECTRICIAN**

**⚠ WARNING:** Risk of fire. Use 120-277V circuit.

**⚠ WARNING:** Risk of shock. An electric current can cause painful shock or serious injury unless handled properly. For your safety, always remember to turn off power supply at the fuse or circuit breaker box before you install the fixture and ground the fixture to avoid potential electric shocks and to ensure reliable starting.

**⚠ WARNING:** Risk of cuts. Some metal parts in the fixture may have sharp edges. To prevent cuts and scrapes, wear gloves when handling the parts.

**⚠ WARNING:** This fixture is designed for use in a circuit protected by a fuse or circuit breaker. It is also designed to be installed in accordance with local electric codes. If you are unsure about your wiring, consult a qualified electrician or a local electrical inspector, and check your local electric code.

**⚠ AVERTISSEMENT:** Risque d'incendie. Utiliser des circuit 120-277V.

**⚠ AVERTISSEMENT:** Risque de choc. Un courant électrique peut causer des chocs douloureux. Pour votre sécurité, vérifiez l'alimentation du boîtier du disjoncteur avant d'installer le projecteur et de le mettre à la terre pour éviter tout risque choc et assurer un démarrage fiable.

**⚠ AVERTISSEMENT:** Risque de coupure. Certaines pièces métalliques de l'appareil peuvent avoir des arêtes vives. Pour éviter les coupures et les éraflures, portez des gants lors de la manipulation des pièces.

**⚠ IMPORTANT:** Cet appareil est conçu pour être utilisé dans un circuit protégé par un fusible ou un disjoncteur. Il est également conçu pour être installé conformément aux codes électriques locaux. En cas de doute sur votre câblage, consultez un électricien qualifié ou un inspecteur en électricité local et vérifiez votre code d'électricité local.



### PACKAGING CONTENTS

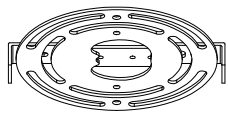

Junction Box Plate

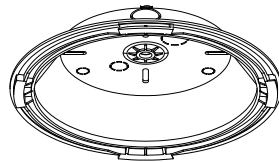

Mounting Bracket

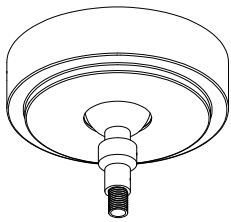

Canopy



Stem(s)



(5) Wire Nuts



(2) Washers

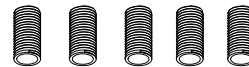

Coupler(s)



(2) Canopy Screws



(2) Junction Box Screws



Hex Nut

### STEM ASSEMBLY

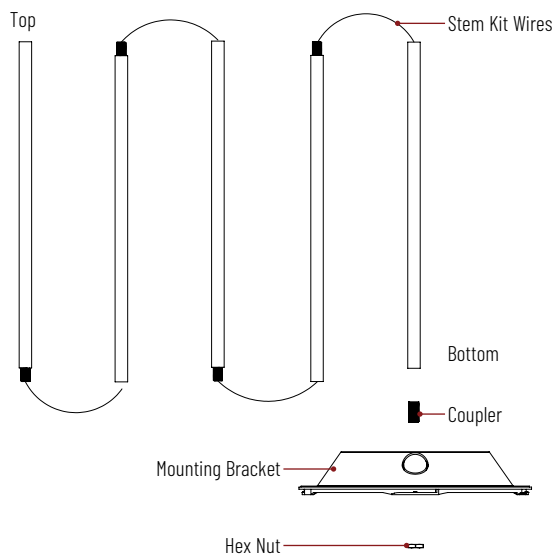

### COMPATIBLE JUNCTION BOXES

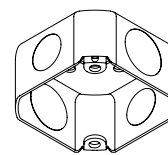

3" Octagonal

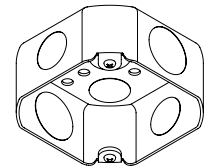

4" Octagonal

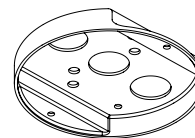

4" Pancake

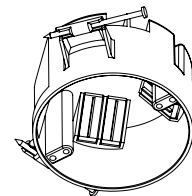

4" Plastic Round

# Installation Instructions

## NELOCAC-16ST

### Stem Kit for 16" ELO

READ PRIOR TO ATTEMPTING INSTALLATION  
ALWAYS TURN OFF MAIN POWER BEFORE INSTALLATION  
INSTALLATION SHOULD BE CARRIED OUT BY YOUR LOCAL ELECTRICIAN

#### INSTALLATION

REQUIRES: NELOCAC-16R (Ordered Separately)

**⚠️ TURN OFF MAIN POWER BEFORE INSTALLATION.**

**DO NOT DISASSEMBLE SCREWS BETWEEN JUNCTION BOX PLATE AND BRACKET.**

1. Attach stems together and thread to coupler. (Figure 1)
2. Attach stem assembly to mounting bracket's coupler and secure mounting bracket with hex nut. (Figure 2)
3. Connect stem kit wires to luminaire's wires with wire nuts. Attach mounting bracket to luminaire and turn clockwise lock. (Figure 3)
4. Route stem kit wires through canopy and attach stem assembly to coupler. (Figure 4)
5. Insert stem kit wires through junction box plate and connect to supply wires (Line/Neutral/Ground) with wire nuts. (Figure 5)
6. Carefully place connection wires inside junction box and attach junction box plate to junction box with (2) junction box screws. (Figure 6)
7. Secure canopy to the junction box plate with (2) canopy screws and washers. (Figure 7)

