

NUTP14 Series

24V High Output COB LED Tape Light

Source: 4.5W/ft. LED

450lm/ft.

PRODUCT DESCRIPTION

24V COB LED Tape creates an uniform seamless line of light, without the need for additional diffused covers or accessories. Producing over 450 lumens per foot in dedicated color temperatures, tape light is a perfect solution for low clearance or reflective surfaces to eliminate all glare or dotting.

FEATURES

- 24V system - requires Class 2 LED driver
- Seamless COB eliminates LED dotting
- Over 450 lumens at 4.5W per foot
- Dedicated color temperatures (2700K, 3000K, 3500K, 4000K)
- Cuttable every 1.79" and connectable with accessories
- Easy installation with 3M™ adhesive pre-installed
- cULus listed for indoor dry locations (IP20 rated)

SPECIFICATION

**Construction:** Uncoated LED tape can be cut every 1.79" at marked intervals. Cutting does not effect circuit and can be connected to accessories. Each roll includes (1) 12" power cord, clear mounting clips and screws.

**Mounting:** Tape light includes pre-installed 3M™ adhesive tape for simple installation. Optional channels or clips are available.

**NATLCB-709:** Clear Mounting Clips (pack of 15)

**NATL2-C23:** 4' Shallow Recessed Channel

**NATL2-C23:** 4' Shallow Recessed Channel

**NATL2-C24:** 4' Shallow Channel

**NATL2-C24:** 4' Shallow Channel

**NATL2-C25:** 4' Deep Recessed Channel

**NATL2-C25:** 4' Deep Recesed Channel

**NATL2-C26:** 4' Deep Channel

**NATL2-C26:** 4' Deep Channel

**NATL2-C27:** 4' J-Style Channel

**NATL2-C28:** 4' Corner Channel

**NATL2-C29:** 4' Trimless Recessed Channel

ELECTRICAL

**Input Voltage:** 24VDC

**Lumens / Wattage:** 450lm / 4.5W per foot

**Color Temperature:** 2700K, 3000K, 3500K or 4000K

**Color Rendering Index:** 90+ CRI

**Beam Spread:** 120° Wide Flood

**Operating Temperature:** -20°C to 45°C

**Dimming:** Specified by driver

**Maximum Length:** 16.4' max.

ACCESORIES

**NATLCB-708:** 12" Hardwire Power Cord

**NATLCB-708/BC:** 6" Power Cord w/Power Line Connector

**NATLCB-TB:** Terminal Block for Cord (not included)

**NATLCB-TB/60:** Terminal Block with 60" Cord (included)

**NATLCB-TB707:** Terminal Block for Tape-to-Tape

**NATLCB-707:** End to End Connector

**NATLCB-703:** 3" Linking Cable

**NATLCB-706:** 6" Linking Cable

**NATLCB-718:** 18" Linking Cable

**NATLCB-736:** 36" Linking Cable

**NATLCB-772:** 72" Linking Cable

**NATLCB-L:** L Connector

**NATLCB-T:** T Connector

**NATLCB-X:** X Connector

LABELS AND LISTINGS

- cULus Listed for Dry Location
- IP20 rated
- RoHS compliant
- 5-Year Limited Warranty



Type

Project

Catalog No.

Notes

Performance Data		
Part Number	Lumens Per Foot	CCT
NUTP14-COB24CVXX-927	409lm/ft.	2700K
NUTP14-COB24CVXX-930	431lm/ft.	3000K
NUTP14-COB24CVXX-935	449lm/ft.	3500K
NUTP14-COB24CVXX-940	469lm/ft.	4000K

PRODUCT IMAGES & DIMENSIONS



Optional Accessories

Description
<b>NATLCB-708</b> = 12" Hardwire Power Cord
<b>NATLCB-708/BC</b> = 6" Power Cord with Female Power Line Connector
<b>NATLCB-TB</b> = Terminal Block for Cord (not included)
<b>NATLCB-TB/60</b> = Terminal Block with 60" Cord (included)
<b>NATLCB-TB707</b> = Terminal Block for Tape-to-Tape
<b>NATLCB-707</b> = End to End Connector
<b>NATLCB-703</b> = 3" Linking Cable
<b>NATLCB-706</b> = 6" Linking Cable
<b>NATLCB-718</b> = 18" Linking Cable
<b>NATLCB-736</b> = 36" Linking Cable
<b>NATLCB-772</b> = 72" Linking Cable
<b>NATLCB-L</b> = L Connector
<b>NATLCB-T</b> = T Connector
<b>NATLCB-X</b> = X Connector
<b>NATL2-C23</b> = 4' Shallow Recessed Channel
<b>NATL2-C23</b> = 4' Shallow Recessed Channel
<b>NATL2-C24</b> = 4' Shallow Channel
<b>NATL2-C24</b> = 4' Shallow Channel
<b>NATL2-C25</b> = 4' Deep Recessed Channel
<b>NATL2-C25</b> = 4' Deep Recessed Channel
<b>NATL2-C26</b> = 4' Deep Channel
<b>NATL2-C26</b> = 4' Deep Channel
<b>NATL2-C27</b> = 4' J-Style Channel
<b>NATL2-C28</b> = 4' Corner Channel
<b>NATL2-C29</b> = 4' Trimless Recessed Channel
<b>NATLCB-709</b> = Clear Mounting Clips (pack of 15)

24V High Output COB LED Tape Light Roll

Length	Color Temperature
NUTP14-COB24CV16 = 16' Roll	-927 = 2700K
NUTP14-COB24CV100 = 100' Roll	-930 = 3000K
	-935 = 3500K
	-940 = 4000K

Example: NUTP14-COB24CV16-930 = 16.4' 24V High Output COB LED Tape Light Roll, 3000K

NUTP14 Series  
24V High Output COB LED Tape Light Accessories

Type

Project

Catalog No.

Notes



12" Hardwire Power Cord

**NATLCB-708**  
12" Cable used to hardwire tape light to a compatible 24VDC LED driver.

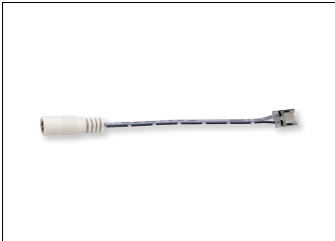

6" Power Cord w/Power Line Connector

**NATLCB-708/BC**  
6" Cable used to connect tape light to a compatible 24VDC LED driver with power line connector.



Terminal Block for Cord (not included)

**NATLCB-TB**  
Terminal block used to connect tape light to power cord (16 awg max., not included). Can also be used to jump power to another run.



Terminal Block with 60" Cord

**NATLCB-TB/60**  
Terminal block used to connect tape light to power cord (16 awg max., not included). Can also be used to jump power to another run.



Terminal Block for Tape-to-Tape

**NATLCB-TB707**  
Terminal block used to connect two tape light sections together.



End to End Connector

**NATLCB-707**  
Connects two tape light sections together.



Linking Cables

<b>NATLCB-703</b>	3" Cable
<b>NATLCB-706</b>	6" Cable
<b>NATLCB-718</b>	18" Cable
<b>NATLCB-736</b>	36" Cable
<b>NATLCB-772</b>	72" Cable
Cable used to connect (2) tape light sections	



L Connector

**NATLCB-L**  
Connects two tape light sections together.

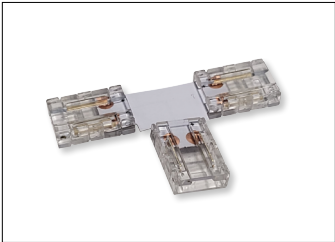

T Connector

**NATLCB-T**  
Connects three tape light sections together.

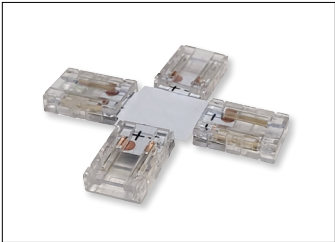

X Connector

**NATLCB-X**  
Connects four tape light sections together.

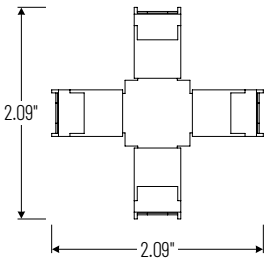
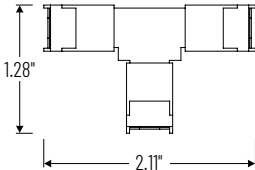
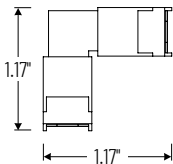

## NUTP14 Series

### 24V High Output COB LED Tape Light Accessories

Type

Project

Catalog No.

Notes

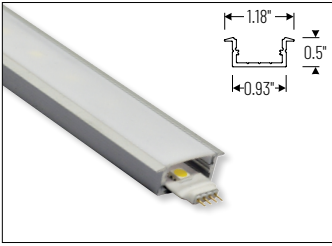

4' Shallow Recessed Channel

#### NATL-C23A

Aluminum Finish

Used to mount tape light recessed in a surface. 4' length and field cuttable. Diffused lens and end caps are included.

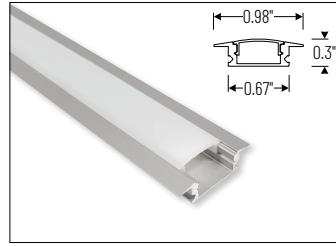

4' Shallow Recessed Channel

#### NATL2-C23A

Aluminum Finish

Used to mount tape light recessed in a surface. 4' length and field cuttable. Diffused lens, end caps and mounting hardware are included.

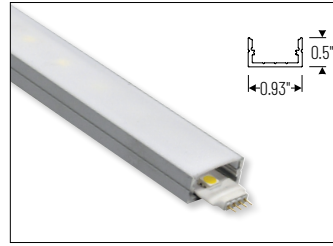

4' Shallow Channel

#### NATL-C24A

Aluminum Finish

Black Finish

White Finish

Used to mount tape light to flat surface. 4' length and field cuttable. Diffused lens and end caps are included.

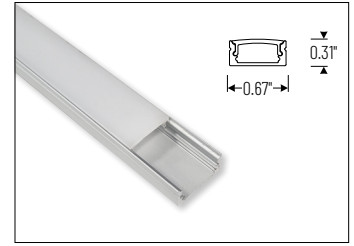

4' Shallow Channel

#### NATL2-C24A

Aluminum Finish

Used to mount tape light to flat surface. 4' length and field cuttable. Diffused lens, end caps and mounting hardware are included.

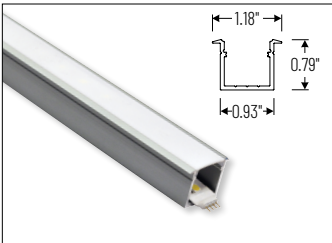

4' Deep Recessed Channel

#### NATL-C25A

Aluminum Finish

Used to mount tape light recessed in a surface. 4' length and field cuttable. Diffused lens and end caps are included.

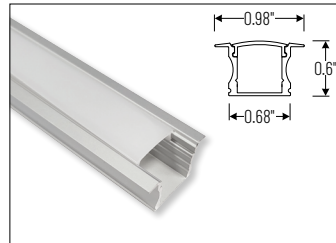

4' Deep Recessed Channel

#### NATL2-C25A

Aluminum Finish

Used to mount tape light recessed in a surface. 4' length and field cuttable. Diffused lens, end caps and mounting hardware are included.

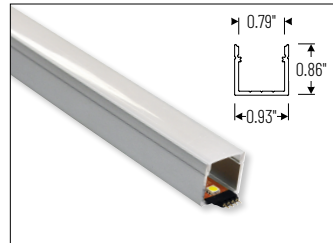

4' Deep Channel

#### NATL-C26A

Aluminum Finish

White Finish

Used to mount tape light to flat surface. 4' length and field cuttable. Diffused lens and end caps are included.

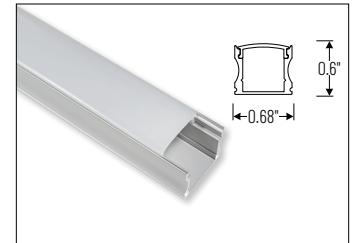

4' Deep Channel

#### NATL2-C26A

Aluminum Finish

Used to mount tape light to flat surface. 4' length and field cuttable. Diffused lens, end caps and mounting hardware are included.

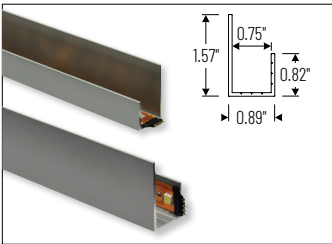

4' J-Style Channel

#### NATL-C27A

Aluminum Finish

Used to mount tape light to flat surface. 4' length and field cuttable.

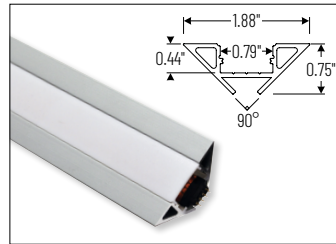

4' Corner Channel

#### NATL2-C28A

Aluminum Finish

**NATL-C28B**  
Black Finish  
**NATL-C28W**  
White Finish  
Used to mount tape light to a corner. 4' length and field cuttable. Diffused lens and end caps are included.

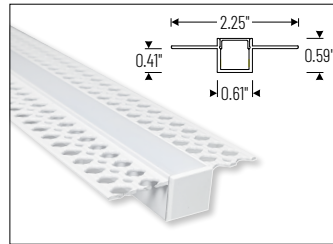

4' Trimless Recessed Channel

#### NATL2-C29W

White Finish

Used to mount tape light in-wall with a seamless appearance. 4' length and field cuttable. Diffused lens and end caps are included.



Clear Mounting Clips

#### NATLCB-709

Pack of 15 clear mounting clips and screws to mount tape light to flat surface.

NUTP14 Series  
24V High Output COB LED Tape Light Drivers & Accessories

Type

Project

Catalog No.

Notes



Direct Plug-In LED Driver

NATL-524W	24V 24W
NATL-545W	24V 45W

Input Voltage: 120V  
Cable Length: 6'



Direct Plug-In LED Driver

NATL-596W	24V 96W
-----------	---------

Input Voltage: 120V  
Input Wire: 44" Cord and Plug  
Output Wire: 58" Power line connector



Class 2 Universal Dimming Driver

NPSU-60W/24	60W
NPSU-96W/24	96W
NPSU-3X96W/24	3x 96W

Input Voltage: 110-277V  
Dimming: Triac, ELV, MLV, 0-10V, PWM  
Note: Power Line Connector(s) not included



Class 2 Hardwire LED Driver  
ELV Dimming

NATLED-5040HW	24V 40W
NATLED-5075HW	24V 75W

Input Voltage: 120V  
Dimming: ELV  
Includes: 10' Power Line Connector



Class 2 Hardwire LED Driver  
MLV Dimming

NMT-48/24C2D1	48W
---------------	-----

Input Voltage: 120V  
Dimming: Magnetic Low Voltage  
Includes: 10' Power Line Connector



Class 2 Hardwire LED Driver  
with Breakers, MLV Dimming

NMT-303/24C2D1	120V input
NMT-303/24C2D2	277V input

Input Voltage: 120V or 277V  
Dimming: Magnetic Low Voltage  
Breakers: (3) 100W  
Note: Power Line Connector(s) not included



Class 2 Hardwire LED Driver  
with Regulator, MLV Dimming

NMTD-60/24D	24V 60W
NMTD-96/24D	24V 96W

Input Voltage: 120-277V  
Dimming: Magnetic Low Voltage  
Regulator: Integral regulator for constant current and voltage  
Includes: 10' Power Line Connector



NEXUS® All-in-One LED Driver and Dimmer

NATL-SWEX60/24A	24V 60W
NATL-SWEX100/24A	24V 100W

Input Voltage: 120V  
Dimming: Integral Dimmer  
Description: Eliminates the driver and allows 120V input and 24V output from a single gang box. 100-5% dimming and on/off switch.



Power Line Connector

NALTL-10	10' Power Line
NALTL-30	30' Power Line

For use with Class 2 drivers. Carries output from driver, requires power line interconnectors.

NATL-302W 5" Splitter

Splits power line connector into two separate leads, requires power line cable.



Touch Dimmer with Memory

NATL-518W

72W max., no power fail memory, touch on/off and hold to dim.



Low Voltage Splice Box

NATL-415W

Use to join low voltage lead to power line connector.



Terminal Block

NATL-407	4-Way
	2-3/8"L x 1-1/8"W x 7/8"D
NATL-408	8-Way
	4"L x 1-1/8"W x 7/8"D



Wire Clip, Plastic - 10pk

NATL-404W	J-Clip
NATL-405W	Over the Wire
NATL-406W	Square Clip



2' Wire Raceway

NATL-422B	Black
NATL-422W	White

Field-cuttable plastic. Includes wire channel with double faced tape and cover.