

# NCH3-6

## 6" Sapphire III New Construction Frame-In

Source: 13W to 60W

900lm to 5500lm

Type

Project

Catalog No.

Notes

### PRODUCT DESCRIPTION

Galvanized steel new construction frame-in riveted to 0.064" steel junction box and driver tray. Plaster frame opening includes (3) "butterfly" spring clips to hold reflector assembly in place.

**Mounting:** Frame-in includes two adjustable bar hangers and universal brackets that accept flat bar hangers, C-Channel (ordered separately) or rigid 1/2" conduit. Adjustable hanger bars with captive nails, alignment foot, T-Bar slot are included on frame. Frame-in includes an adjustable deep ceiling collar that accommodates ceiling thickness from 1/2" to 2".

**Minimum Clearances:** Frames require a minimum of 3" from thermal insulation and 1/2" from adjacent building component.

**Junction Box:** Plaster frame integrated 29 cubic inch 0.064" thick galvanized steel, with seven 1/2" knockouts, four pryouts, and snap on cover. Electrical connections are made through a single junction box door. Green wire provided for installations with ground wire fed through PVC pipe conduit. Junction box connects to reflector assembly with lockable quick connect.

**Thermal Protector:** Phase dimming drivers require an external thermal device, which is located on the junction box; Other drivers are thermally protected.

**Driver:** Isolated driver separates the primary side from the secondary side.

ELECTRICAL	L1	L2	L3	L4	L5	L6
<b>Input Voltage</b>	120VAC or 120-277VAC		120VAC or 277VAC			
<b>Input Power</b>	13W max.	18W max.	26W max.	38W max.	46W max.	60W max.
<b>Power Factor</b>	≥0.90					
<b>Dimming</b>	Triac/ELV or 0-10V					
<b>Operating Temperature</b>	0°C to 40°C	0°C to 40°C	0°C to 35°C	0°C to 35°C	0°C to 25°C	0°C to 25°C
<b>Compatible Reflectors</b>	NC3-61L1 NC3-66L1 NC3-68L1	NC3-61L2 NC3-66L2 NC3-68L2	NC3-61L3 NC3-66L3 NC3-68L3	NC3-61L4 NC3-66L4 NC3-68L4	NC3-61L5 NC3-66L5 NC3-68L5	NC3-61L6

### Emergency LED Driver

- Up to 7W emergency illumination with LEDs
- Illumination Time: 90 minutes
- Voltage: 120-277VAC, 50/60Hz
- Output Voltage: 10-60 VDC
- Available with remote or integral test switch (must specify)

### LABELS AND LISTINGS

- cULus Listed for Damp Locations (Wet Locations when used with compatible reflector)
- [5-Year Limited Warranty](#)
- RoHS Compliant
- FCC Compliant
- Emergency LED Driver meets Title 20 CEC efficiency standards



### PRODUCT IMAGES AND DIMENSIONS

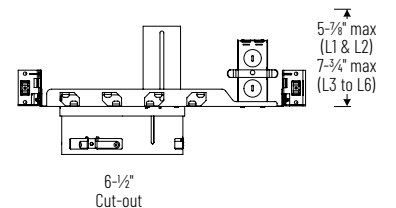
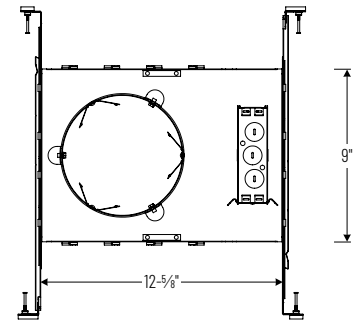
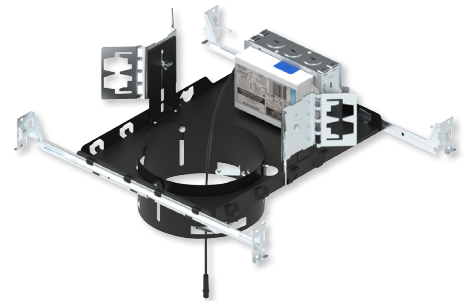

## 6" Sapphire III New Construction Frame-In - Compatible with Sapphire III Reflectors

Lumens / Wattage	Input Voltage / Dimming	Optional Emergency
<b>NCH3-6L1</b> = 900lm / 13W	<b>P01</b> = 120V; Phase Dimming (Triac/ELV)	<b>EM</b> = Emergency Pack w/ Remote Test Switch
<b>NCH3-6L2</b> = 1500lm / 18W	<b>C12</b> = 120-277V; 0-10V Dimming	<b>EMI</b> = Emergency Pack w/ Integral Test Switch (Compatible with NC3-61 only, must specify on reflector)
<b>NCH3-6L3</b> = 2500lm / 26W	<b>P01</b> = 120V; Phase Dimming (Triac/ELV)	<b>EM</b> = Emergency Pack w/ Remote Test Switch
<b>NCH3-6L4</b> = 3500lm / 38W	<b>C01</b> = 120V; 0-10V Dimming	<b>EMI</b> = Emergency Pack w/ Integral Test Switch
<b>NCH3-6L5</b> = 4500lm / 46W	<b>C02</b> = 277V; 0-10V Dimming	(Compatible with NC3-61 only, must specify on reflector)
<b>NCH3-6L6</b> = 5500lm / 60W		

Example: **NCH3-6L6C02** = 6" Sapphire III New Construction Frame-In, 5500lm / 60W, 277V input; 0-10V dimming