

# NYLS3-6

## 6" High Performance Sapphire III Cylinder

Source: 11W to 58W

900lm to 5500lm

Type

Project

Catalog No.

Notes

### PRODUCT DESCRIPTION

The architectural grade Sapphire III high lumen LED cylinders are a perfect solution for lobbies, corridors, offices and conference rooms. The Sapphire III utilizes Signify® Fortimo COB LED technology for better optic control with three specified beam spreads. Beam spreads focus the light down to the work plane from high ceiling applications. The reflectors have been designed for the high efficiency (LPW) while providing low aperture brightness. The Sapphire III luminaires are proudly assembled in the USA.

### CONSTRUCTION

**Cylinder Cap:** High quality 0.040" steel cap with universal slots to allow for direct mounting to junction box for surface mount. Incorporates all thread in the center for the installation of a cable or pendant rod kit for the corresponding mounting method. Three screws on the bottom of cap secure cylinder body to cylinder cap. (Adjustable with flathead screw drive)

**Cylinder Body:** 0.040" steel cylindrical body with three keyhole slots allowing body to be installed to cylinder cap. Spring brackets accept torsion wing trim springs. Four butterfly clips also accommodated for spring-less trims.

### INSTALLATION

**Cable Mount:** Cylinder comes with 8' of field cuttable aircraft cable and offset cable (5-wire) for power and dimming.

**Stem Mount:** Cylinder includes a swivel canopy and 7' (consisting of (3) 12" and (2) 24") of internally threaded rod. Swivel canopy is compatible with sloped ceilings with a ceiling pitch from 1/12 to 10/12.

**Surface & Wall Mount:** Cylinder is supplied with hardware to mount directly over junction box.

**Emergency:** Cylinder can be specified with connections for emergency battery installation. Must specify battery with remote test switch separately ([NEPK-07LEDUNV](#)). Not compatible with stem mount option.

### LISTINGS AND WARRANTY

- cULus Listed for Damp Locations (Wall Mount is Wet Location)
- [5-Year Limited Warranty](#)
- ENERGY STAR certified
- FCC Compliant



### PRODUCT IMAGES



**NYLS3-6C**  
Cable Mounted



**NYLS3-6P**  
Pendant Mounted



**NYLS3-6S**  
Surface Mounted



**NYLS3-6W**  
Wall Mounted

### PRODUCT DIMENSIONS

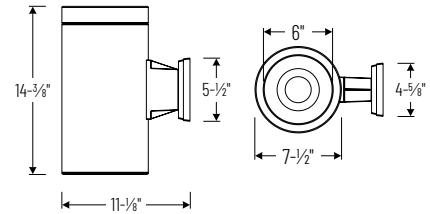

ELECTRICAL	L1	L2	L3	L4	L5	L6
<b>Input Voltage</b>	120VAC or 120-277VAC					
<b>Input Power</b>	11W max.	16W max.	24W max.	36W max.	44W max.	58W max.
<b>Compatible Trim</b>	NYLS3-6x1L1 NYLS3-6x6L1 NYLS3-6x8L1	NYLS3-6x1L2 NYLS3-6x6L2 NYLS3-6x8L2	NYLS3-6x1L3 NYLS3-6x6L3 NYLS3-6x8L3	NYLS3-6x1L4 NYLS3-6x6L4 NYLS3-6x8L4	NYLS3-6x1L5 NYLS3-6x6L5 NYLS3-6x8L5	NYLS3-6x1L6
<b>Delivered Lumens</b>	900lm	1500lm	2500lm	3500lm	4500lm	5500lm
<b>Color Temperature</b>	2700K, 3000K, 3500K or 4000K					
<b>Color Rendering Index</b>	90+ CRI					
<b>Beam Spread</b>	38° Spot, 56° Narrow Flood or 72° Flood					
<b>Dimming</b>	Triac/ELV or 0-10V					
<b>Operating Temperature</b>	0°C to 45°C	0°C to 45°C	0°C to 35°C	0°C to 35°C	0°C to 25°C	0°C to 25°C
<b>Lifetime</b>	50,000 hours @ L70					

### 6" Specifiable Beam Spread Sapphire III Cylinder

Mounting Type	Trim Type	Lumen / Wattage	CCT	Optic	Input Voltage / Dimming	Reflector / Flange Finish	Cyl Finish	Optional Emergency
<b>NYLS3-6C</b> = Cable	<b>1</b> = Reflector	<b>L1</b> = 900lm / 11W	<b>27</b> = 2700K	<b>S</b> = SP	<b>P01</b> = 120V Triac/ELV	<b>BB</b> = Black / Black	<b>B</b> = Black	<b>/PEM</b> = Pre-Wired for Emergency <sup>2</sup>
<b>NYLS3-6P</b> = Stem	<b>6</b> = Wall Wash <sup>1</sup>	<b>L2</b> = 1500lm / 16W	<b>30</b> = 3000K	<b>N</b> = NFL	<b>C12</b> = 120-277V 0-10V	<b>BW</b> = Black / Matte Powder White	<b>W</b> = White	
<b>NYLS3-6S</b> = Surface	<b>8</b> = Deco Glass* <sup>1</sup>	<b>L3</b> = 2500lm / 24W	<b>35</b> = 3500K	<b>F</b> = FL		<b>CC</b> = Clear / Clear <sup>1</sup>		<sup>2</sup> Not compatible w/stem
<b>NYLS3-6W</b> = Wall	<sup>1</sup> Not compatible w/L6	<b>L4</b> = 3500lm / 36W	<b>40</b> = 4000K			<b>DB</b> = Diffused Clear / Black		
		<b>L5</b> = 4500lm / 44W				<b>DD</b> = Diffused Clear / Diffused		
		<b>L6</b> = 5500lm / 58W				<b>DW</b> = Diffused Clear / Matte Powder White		
						<b>HB</b> = Haze / Black		
						<b>HW</b> = Haze / Matte Powder White		
						<b>HZ</b> = Haze / Haze		
						<b>WW</b> = Matte Powder White		

<sup>1</sup> Not available with wall wash

#### \* Deco Glass Option

- NTG-6CF** Tempered Clear Glass with Frosted Center
- NTG-6FC** Tempered Frosted Glass with Clear Center
- NTG-6HC** Tempered Clear Glass with Frosted Center and 3-1/8" Open Center

Example: **NYLS3-6SIL630C12HBB** = 6" Sapphire III LED Cylinder, Surface Mount, 120-277V input; 0-10V dimming, 5500lm / 58W, 3000K, Spot Beam Spread, Haze Reflector / Black Flange with Black Cylinder

# NYLS3-6C

6" High Performance Sapphire III Cylinder

Source: 11W to 58W

900lm to 5500lm

Type

Project

Catalog No.

Notes

## Cable Mounted - Product Images



**NYLS3-6C1LxxxBBB**

Black Reflector  
Black Flange  
Black Cylinder



**NYLS3-6C1LxxxBWB**

Black Reflector  
Matte Powder White Flange  
Black Cylinder



**NYLS3-6C1LxxxCCB**

Clear Reflector  
Clear Flange  
Black Cylinder



**NYLS3-6C1LxxxDBB**

Diffused Clear Reflector  
Black Flange  
Black Cylinder



**NYLS3-6C1Lxxxddb**

Diffused Clear Reflector  
Diffused Flange  
Black Cylinder



**NYLS3-6C1LxxxDBW**

Diffused Clear Reflector  
Matte Powder White Flange  
Black Cylinder



**NYLS3-6C1LxxxHBB**

Haze Reflector  
Black Flange  
Black Cylinder



**NYLS3-6C1LxxxHWB**

Haze Reflector  
Matte Powder White Flange  
Black Cylinder



**NYLS3-6C1LxxxHZZ**

Haze Reflector  
Haze Flange  
Black Cylinder



**NYLS3-6C1LxxxWWB**

Matte Powder White Reflector  
Matte Powder White Flange  
Black Cylinder



**NYLS3-6C1LxxxDWB**

Black Reflector  
Black Flange  
White Cylinder



**NYLS3-6C1LxxxBWW**

Black Reflector  
Matte Powder White Flange  
White Cylinder



**NYLS3-6C1LxxxCCW**

Clear Reflector  
Clear Flange  
White Cylinder



**NYLS3-6C1LxxxDBW**

Diffused Clear Reflector  
Black Flange  
White Cylinder



**NYLS3-6C1LxxxDDW**

Diffused Clear Reflector  
Diffused Flange  
White Cylinder



**NYLS3-6C1LxxxDWW**

Diffused Clear Reflector  
Matte Powder White Flange  
White Cylinder



**NYLS3-6C1LxxxHWW**

Haze Reflector  
Black Flange  
White Cylinder



**NYLS3-6C1LxxxHWW**

Haze Reflector  
Matte Powder White Flange  
White Cylinder



**NYLS3-6C1LxxxHZZ**

Haze Reflector  
Haze Flange  
White Cylinder



**NYLS3-6C1LxxxWWW**

Matte Powder White Reflector  
Matte Powder White Flange  
White Cylinder

# NYLS3-6P

6" High Performance Sapphire III Cylinder

Source: 11W to 58W

900lm to 5500lm

Type

Project

Catalog No.

Notes

## Stem Mounted - Product Images



**NYLS3-6PILxxxBBB**

Black Reflector  
Black Flange  
Black Cylinder



**NYLS3-6PILxxxBWB**

Black Reflector  
Matte Powder White Flange  
Black Cylinder



**NYLS3-6PILxxxCCB**

Diffused Clear Reflector  
Black Flange  
Black Cylinder



**NYLS3-6PILxxxDBB**

Diffused Clear Reflector  
Black Flange  
Black Cylinder



**NYLS3-6PILxxxddb**

Diffused Clear Reflector  
Diffused Flange  
Black Cylinder



**NYLS3-6PILxxxDWB**

Diffused Clear Reflector  
Matte Powder White Flange  
Black Cylinder



**NYLS3-6PILxxxHBB**

Haze Reflector  
Black Flange  
Black Cylinder



**NYLS3-6PILxxxHBB**

Haze Reflector  
Matte Powder White Flange  
Black Cylinder



**NYLS3-6PILxxxHBB**

Haze Reflector  
Haze Flange  
Black Cylinder



**NYLS3-6PILxxxWBB**

Matte Powder White Reflector  
Matte Powder White Flange  
Black Cylinder



**NYLS3-6PILxxxBBW**

Black Reflector  
Black Flange  
White Cylinder



**NYLS3-6PILxxxBWW**

Black Reflector  
Matte Powder White Flange  
White Cylinder



**NYLS3-6PILxxxCCW**

Clear Reflector  
Clear Flange  
White Cylinder



**NYLS3-6PILxxxDBW**

Diffused Clear Reflector  
Black Flange  
White Cylinder



**NYLS3-6PILxxxDDW**

Diffused Clear Reflector  
Diffused Flange  
White Cylinder



**NYLS3-6PILxxxDWW**

Diffused Clear Reflector  
Matte Powder White Flange  
White Cylinder



**NYLS3-6PILxxxHBB**

Haze Reflector  
Black Flange  
White Cylinder



**NYLS3-6PILxxxHBB**

Haze Reflector  
Matte Powder White Flange  
White Cylinder



**NYLS3-6PILxxxHBB**

Haze Reflector  
Haze Flange  
White Cylinder



**NYLS3-6PILxxxWBB**

Matte Powder White Reflector  
Matte Powder White Flange  
White Cylinder

# NYLS3-6S

6" High Performance Sapphire III Cylinder

Source: 11W to 58W

900lm to 5500lm

Type

Project

Catalog No.

Notes

## Surface Mounted - Product Images



**NYLS3-6S1LxxxBBB**

Black Reflector  
Black Flange  
Black Cylinder



**NYLS3-6S1LxxxBWB**

Black Reflector  
Matte Powder White Flange  
Black Cylinder



**NYLS3-6S1LxxxCCB**

Clear Reflector  
Clear Flange  
Black Cylinder



**NYLS3-6S1LxxxDBB**

Diffused Clear Reflector  
Black Flange  
Black Cylinder



**NYLS3-6S1LxxxDDB**

Diffused Clear Reflector  
Diffused Flange  
Black Cylinder



**NYLS3-6S1LxxxDWB**

Diffused Clear Reflector  
Matte Powder White Flange  
Black Cylinder



**NYLS3-6S1LxxxHBB**

Haze Reflector  
Black Flange  
Black Cylinder



**NYLS3-6S1LxxxHWB**

Haze Reflector  
Matte Powder White Flange  
Black Cylinder



**NYLS3-6S1LxxxHDB**

Haze Reflector  
Haze Flange  
Black Cylinder



**NYLS3-6S1LxxxWBB**

Matte Powder White Reflector  
Matte Powder White Flange  
Black Cylinder



**NYLS3-6S1LxxxBBW**

Black Reflector  
Black Flange  
White Cylinder



**NYLS3-6S1LxxxBWW**

Black Reflector  
Matte Powder White Flange  
White Cylinder



**NYLS3-6S1LxxxCCW**

Clear Reflector  
Clear Flange  
White Cylinder



**NYLS3-6S1LxxxDBW**

Diffused Clear Reflector  
Black Flange  
White Cylinder



**NYLS3-6S1LxxxDDW**

Diffused Clear Reflector  
Diffused Flange  
White Cylinder



**NYLS3-6S1LxxxDWW**

Diffused Clear Reflector  
Matte Powder White Flange  
White Cylinder



**NYLS3-6S1LxxxHBBW**

Haze Reflector  
Black Flange  
White Cylinder



**NYLS3-6S1LxxxHBWW**

Haze Reflector  
Matte Powder White Flange  
White Cylinder



**NYLS3-6S1LxxxHDBW**

Haze Reflector  
Haze Flange  
White Cylinder



**NYLS3-6S1LxxxWBBW**

Matte Powder White Reflector  
Matte Powder White Flange  
White Cylinder

# NYLS3-6W

6" High Performance Sapphire III Cylinder

Source: 11W to 58W

900lm to 5500lm

Type

Project

Catalog No.

Notes

## Wall Mounted - Product Images



**NYLS3-6W1LxxxBBB**

Black Reflector  
Black Flange  
Black Cylinder



**NYLS3-6W1LxxxBWB**

Black Reflector  
Matte Powder White Flange  
Black Cylinder



**NYLS3-6W1LxxxCCB**

Clear Reflector  
Clear Flange  
Black Cylinder



**NYLS3-6W1LxxxDBB**

Diffused Clear Reflector  
Diffused Flange  
Black Cylinder



**NYLS3-6W1LxxxDDB**

Diffused Clear Reflector  
Diffused Flange  
Black Cylinder



**NYLS3-6W1LxxxDWB**

Diffused Clear Reflector  
Matte Powder White Flange  
Black Cylinder



**NYLS3-6W1LxxxHBB**

Haze Reflector  
Black Flange  
Black Cylinder



**NYLS3-6W1LxxxHNB**

Haze Reflector  
Matte Powder White Flange  
Black Cylinder



**NYLS3-6W1LxxxHDB**

Haze Reflector  
Haze Flange  
Black Cylinder



**NYLS3-6W1LxxxWBB**

Matte Powder White Reflector  
Matte Powder White Flange  
Black Cylinder



**NYLS3-6W1LxxxBBW**

Black Reflector  
Black Flange  
White Cylinder



**NYLS3-6W1LxxxBWW**

Black Reflector  
Matte Powder White Flange  
White Cylinder



**NYLS3-6W1LxxxCCW**

Clear Reflector  
Clear Flange  
White Cylinder



**NYLS3-6W1LxxxDBW**

Diffused Clear Reflector  
Black Flange  
White Cylinder



**NYLS3-6W1LxxxDDW**

Diffused Clear Reflector  
Diffused Flange  
White Cylinder



**NYLS3-6W1LxxxDWW**

Diffused Clear Reflector  
Matte Powder White Flange  
White Cylinder



**NYLS3-6W1LxxxHNB**

Haze Reflector  
Black Flange  
White Cylinder



**NYLS3-6W1LxxxHNB**

Haze Reflector  
Matte Powder White Flange  
White Cylinder



**NYLS3-6W1LxxxHDB**

Haze Reflector  
Haze Flange  
White Cylinder



**NYLS3-6W1LxxxWBB**

Matte Powder White Reflector  
Matte Powder White Flange  
White Cylinder

# PHOTOMETRICS

6" High Performance Sapphire III Cylinder  
5500lm / 60W

Type

Project

Catalog No.

Notes

## Test Information

Test Number: NTR2350R1  
Part Number: NYLS3-6S1L640SC12WWW  
Beam Spread: 38° Spot  
Lumens: 5673lm  
Wattage: 56.59W  
Efficacy: 100lpw  
CCT / CRI: 4000K / 90 CRI  
Spacing Criteria (0°-180°): 0.62  
Spacing Criteria (90°-270°): 0.62

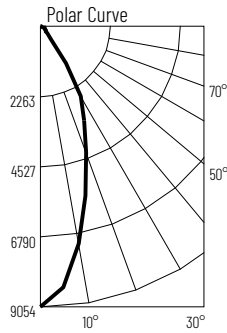

## Illuminance at a Distance

Distance from Luminaire	FC at Nadir	Beam Diameter
8'	141fc	5'-7"
12'	62.9fc	8'-5"
16'	35.4fc	11'-2"
20'	22.6fc	14'
24'	15.7fc	16'-10"

## Zonal Lumen Summary

Zone	Lumens	% Luminaire
0-30	3900	68.8
0-40	4883	86.1
0-60	5362	94.5
0-90	5673	100
90-180	0	0
0-180	5673	100

## Candela Table

Vertical Angles	Candela
0	9054
5	8452
15	5655
25	3344
35	1462
45	307

## Test Information

Test Number: NTR2349R1  
Part Number: NYLS3-6S1L640NC12WWW  
Beam Spread: 56° Narrow Flood  
Lumens: 5709lm  
Wattage: 56.65W  
Efficacy: 101lpw  
CCT / CRI: 4000K / 90 CRI  
Spacing Criteria (0°-180°): 0.86  
Spacing Criteria (90°-270°): 0.86

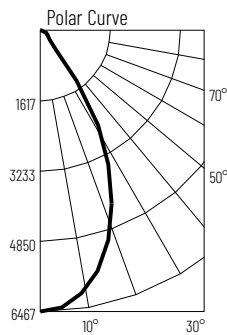

## Illuminance at a Distance

Distance from Luminaire	FC at Nadir	Beam Diameter
8'	101fc	8'-7"
12'	44.9fc	12'-11"
16'	25.3fc	17'-1"
20'	16.2fc	21'-5"
24'	11.2fc	25'-8"

## Zonal Lumen Summary

Zone	Lumens	% Luminaire
0-30	3364	58.9
0-40	4654	81.5
0-60	5377	94.2
0-90	5709	100
90-180	0	0
0-180	5709	100

## Candela Table

Vertical Angles	Candela
0	6467
5	6361
15	5481
25	3838
35	1679
45	305

## Test Information

Test Number: NTR2343R1  
Part Number: NYLS3-6S1L640FC12WWW  
Beam Spread: 72° Flood  
Lumens: 5003lm  
Wattage: 56.68W  
Efficacy: 88lpw  
CCT / CRI: 4000K / 90 CRI  
Spacing Criteria (0°-180°): 1.18  
Spacing Criteria (90°-270°): 1.16

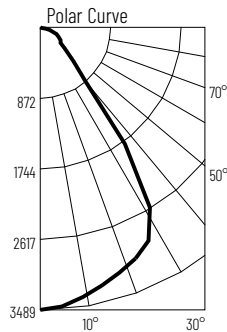

## Illuminance at a Distance

Distance from Luminaire	FC at Nadir	Beam Diameter
8'	54.5fc	11'-8"
12'	24.2fc	17'-7"
16'	13.6fc	23'-5"
20'	8.7fc	29'-4"
24'	6.1fc	35'-1"

## Zonal Lumen Summary

Zone	Lumens	% Luminaire
0-30	2168	43.3
0-40	3449	68.9
0-60	4535	90.7
0-90	5003	100
90-180	0	0
0-180	5003	100

## Candela Table

Vertical Angles	Candela
0	3489
5	3448
15	3243
25	3014
35	1965
45	589

## Lumen Output Multipliers

Lumen Package: L1 (0.18), L2 (0.25), L3 (0.47), L4 (0.67), L5 (0.8), L6 (1.00)  
Color Temperature: 2700K (0.5), 3000K (0.91), 3500K (0.97), 4000K (1.00)  
Reflector Finish: Black (0.68), Specular Clear (1.08), Diffused (1.08), Haze (0.96), Matte Powder White (1.00)