

NAPF-3SPH
3" Apollo Square Flanged Pinhole

PRODUCT DESCRIPTION
3" Apollo flanged pinholes feature a 1.67" x 1.67" opening with exceptional glare control for a quiet ceiling appearance.

- FEATURES
- Precision-crafted micro flange
  - Architectural grade finishes
  - Exceptional glare control
  - Compatible with adjustable LED mechanism (361° rotation & 45° tilt)
  - cULus Listed for wet locations when used with lens

SPECIFICATION
Trim: Die-cast aluminum construction with architectural grade finishes. Protective e-coating for corrosion protection and durability.

Lens: Luminaire can be specified with clear lens (pre-installed). Wet location rated when used with lens.

Mounting: Trim easily installs into housing collar for installation.

COMPATIBLE HOUSINGS

CATALOG NO.	DESCRIPTION
NHAP-3S	3" Apollo Non-IC Air-Tight New Construction Housing with Field Changeable Optics (2500lm or 3000lm)
NHAPIC-3S	3" Apollo IC Air-Tight New Construction Housing with Field Changeable Optics (1000lm to 2000lm)

LABELS AND LISTINGS
cULus Listed for Damp Location (Wet Location when used with lens)



Type
Project
Catalog No.
Notes

APOLLO
PRODUCT IMAGES AND DIMENSIONS

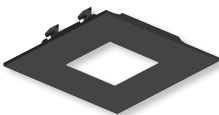
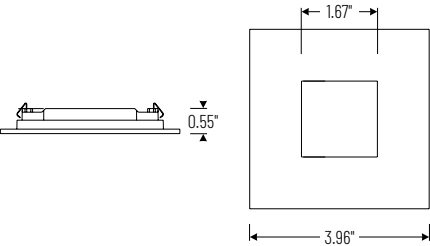

NAPF-3SPHB
Black



NAPF-3SPHBZ
Bronze



NAPF-3SPHMPW
Matte Powder White

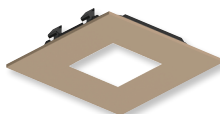

NAPF-3SPHWD
Wheat Diffused

3" Apollo Square Flanged Pinhole

Finish	Optional Lens
NAPF-3SPHB = Black	(blank) = No Lens
NAPF-3SPHBZ = Bronze	/CL = Clear Lens (Wet Location)
NAPF-3SPHMPW = Matte Powder White	
NAPF-3SPHWD = Wheat Diffused	

Example: NAPF-3SPHMPW = 3" Square Flanged Pinhole, Matte Powder White finish