

Installation Instructions

NX-822-LED

Surface Adjustable LED Exit Sign with 8" Letters (NY Approved)

READ PRIOR TO ATTEMPTING INSTALLATION
ALWAYS TURN OFF MAIN POWER BEFORE INSTALLATION
INSTALLATION SHOULD BE CARRIED OUT BY YOUR LOCAL ELECTRICIAN

⚠ WARNING - This equipment is intended to be installed only by qualified personnel. The installation must be made in accordance with the current edition to the National Electric Code and all applicable state and local building codes. The final installation must be approved by the appropriate qualified electrical/building inspector(s). Improper installation may result in a fire or electrical hazard. Be sure the electrical power to the circuit has been disconnected before installing this electrical system.

⚠ AVERTISSEMENT - Cet équipement est destiné à être installé uniquement par du personnel qualifié. L'installation doit être faite en conformité avec l'édition actuelle du Code national de l'électricité et toutes étatiques et locales codes du bâtiment applicables. L'installation finale doit être approuvée par l'inspecteur en électricité / bâtiment qualifié approprié(s). Une mauvaise installation peut entraîner un incendie ou un risque électrique. Soyez sûr de la puissance électrique vers le circuit a été coupée avant l'installation de ce système électrique.

IMPORTANT SAFEGUARDS

READ AND FOLLOW ALL SAFETY INSTRUCTIONS

When using electrical equipment, basic safety precautions should always be followed including the following:

1. Before starting the installation, disconnect the power by turning off the circuit breaker or by removing the appropriate fuse at the fuse box. Using the light switch to turning the power off is not sufficient to prevent electrical shock.
2. Do not use outdoors.
3. Do not mount near gas or electric heaters.
4. Use caution when servicing batteries. Battery acid can cause burns to skin and eyes. If acid is spilled on skin or eyes, flush acid with fresh water and contact a physician immediately.
5. Equipment should be mounted in locations and at heights where it will not be subjected to tampering by unauthorized personnel.
6. The use of accessory equipment not recommended by the manufacturer may cause an unsafe condition.
7. Do not use this equipment for other than its intended use.
8. All servicings should be performed by a qualified personnel only.
9. Allow battery to charge for 24 hours before first use.

SAVE THESE INSTRUCTIONS

MAINTENANCE

Always disconnect power at fuse or circuit breaker before installing or servicing, servicing should be performed only by qualified personnel.

Battery needs to be recharged if product is kept in stock over 9 months. We recommend that the equipment be tested regularly in accordance with local codes. Replace batteries as needed if discharge time does achieve 90 minutes.

OPERATION

1. Apply AC power to the unit, the LED indicator will show red.
2. Press and hold the test button, the exit sign will now be powered by the battery backup and the LED indicator will be turned off.
3. Release the test switch, the exit sign will now return to AC power and the LED indicator will turn back to red.

TROUBLESHOOTING GUIDE

If LED heads or LED indicator do not illuminate, check the following:

1. Check AC supply - verify that unit has 24 hours of AC voltage.
2. Check battery connection.
3. Discharge the battery, charge for 24 hours, and then retest.
4. If above troubleshooting does not solve your problem, contact factory for assistance.

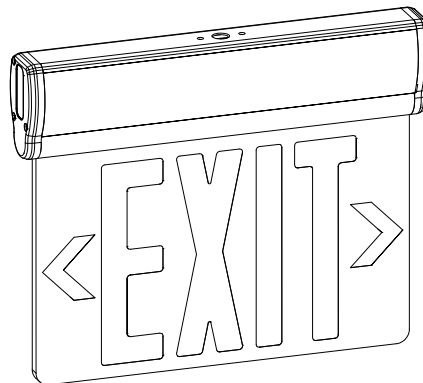

Installation Instructions

NX-822-LED

Surface Adjustable LED Exit Sign with 8" Letters (NY Approved)

READ PRIOR TO ATTEMPTING INSTALLATION
ALWAYS TURN OFF MAIN POWER BEFORE INSTALLATION
INSTALLATION SHOULD BE CARRIED OUT BY YOUR LOCAL ELECTRICIAN

EXPLODED VIEW

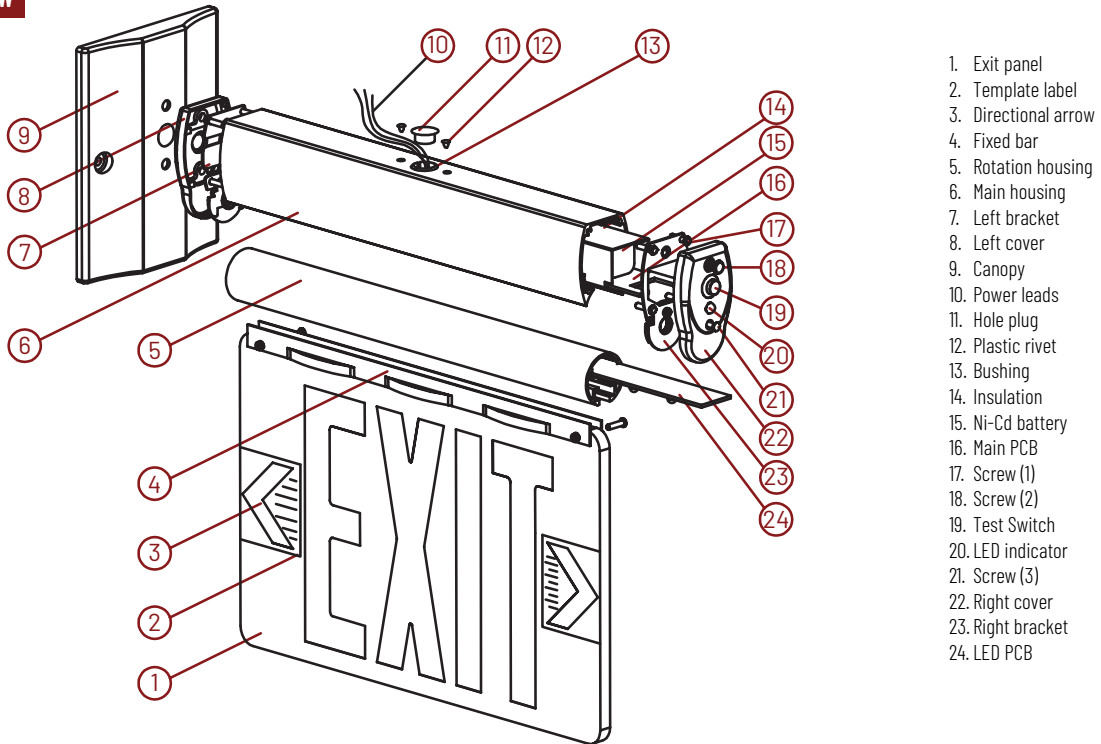

ELECTRICAL CONNECTIONS

Make the proper supply lead connections. If using 120VAC, connect the black and white leads to the building utility. If using 277VAC, connect the orange and white leads to the building utility. Cap off unused wires. In all cases, use standard wire nuts in connection to leads.

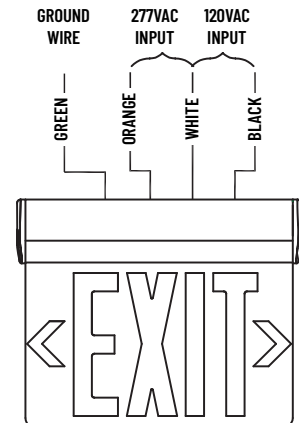

DETERMINE CHEVRON DIRECTION

Fix chevron(s) as required to EXIT panel and remove the template from the panel.
NOTE: When chevron(s) are being taped on the EXIT panel, you can not use it again one you remove it. Please be careful before removing chevron(s).

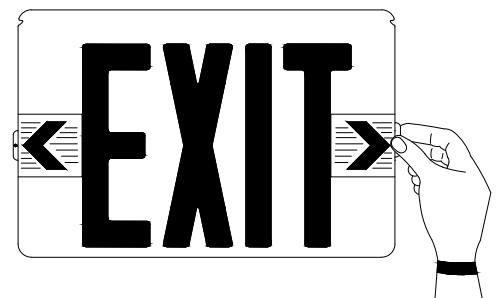

Installation Instructions

NX-822-LED

Surface Adjustable LED Exit Sign with 8" Letters (NY Approved)

READ PRIOR TO ATTEMPTING INSTALLATION
ALWAYS TURN OFF MAIN POWER BEFORE INSTALLATION
INSTALLATION SHOULD BE CARRIED OUT BY YOUR LOCAL ELECTRICIAN

CEILING / WALL MOUNTING

- 1** Attach crossbar to junction box, using screw if needed. (not provided)

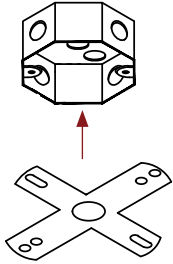

- 2** Use screwdriver open front cover to connect battery connector.

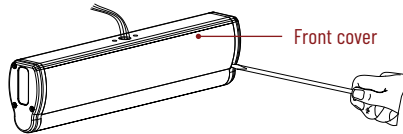

- 3** Feed AC supply leads through canopy center hole. Assemble canopy on aluminum housing with (2) PM4*12 screws (included) and make proper lead connections. See Electrical Connections.

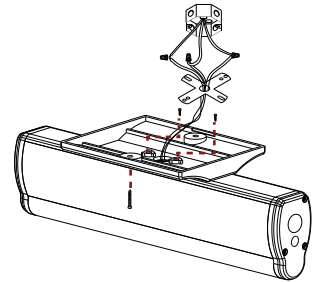

- 4** Using (2) M4*40 screws (included), tighten canopy to mounting plate.

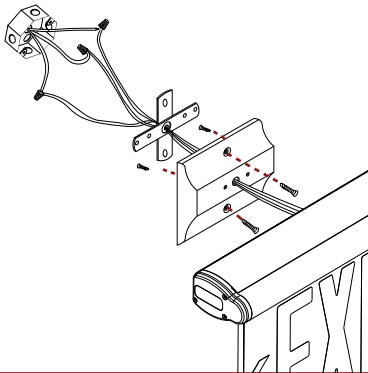

- 5** Peel off protection film from both sides of EXIT panel, Insert EXIT panel into main body assembly gently.

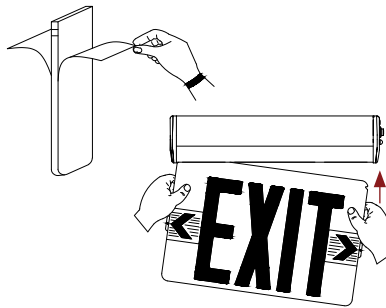

- 6** Determine direction for chevron placement. If EXIT panel is for single face, make sure EXIT chevron direction is correct. (See page 2)



- 7** The unit may be installed on any surface and rotate EXIT panel in any angle from 0° to 180°, lock EXIT panel by mounting lock screw. (ceiling mount rotated to 90° will become a wall mount)

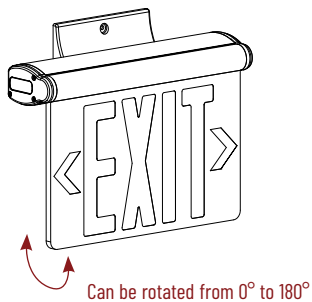

Installation Instructions

NX-822-LED

Surface Adjustable LED Exit Sign with 8" Letters (NY Approved)

READ PRIOR TO ATTEMPTING INSTALLATION
ALWAYS TURN OFF MAIN POWER BEFORE INSTALLATION
INSTALLATION SHOULD BE CARRIED OUT BY YOUR LOCAL ELECTRICIAN

SURFACE END MOUNTING

- 1** Attach crossbar to junction box, using screw if needed. (not provided)

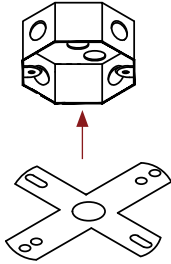

- 2** Use screwdriver open front cover to connect battery connector. Remove the hole plug from mounting end cap.

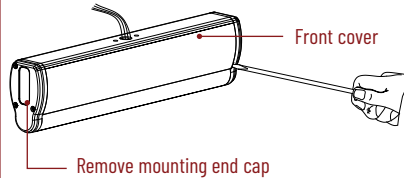

- 3** Feed AC supply leads through canopy center hole. Assemble canopy on aluminum housing with (2) PM4*12 screws (included) and make proper lead connections. See Electrical Connections.

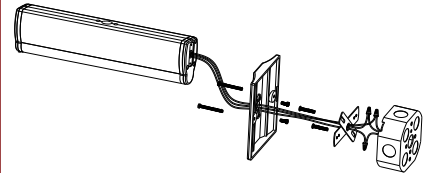

- 4** Using (2) M4*40 screws (included), tighten canopy to mounting plate.

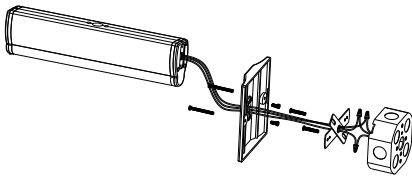

- 5** Peel off protection film from both sides of EXIT panel, Insert EXIT panel into main body assembly gently.

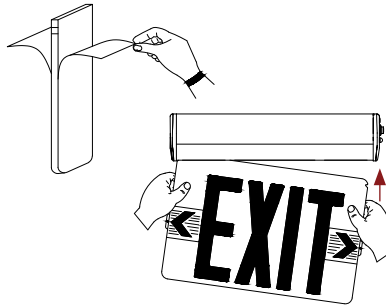

- 6** Determine direction for chevron placement. If EXIT panel is for single face, make sure EXIT chevron direction is correct. (See page 2)



- 7** The unit may be installed on any surface and rotate EXIT panel in any angle from 0° to 180°, lock EXIT panel by mounting lock screw.

